

PLCM10 Tech-Note

LTE Modem Plug-In

- 4G wireless communication module
- Supports LTE cat. 4 Global, UMTS/DC-HS DPA/HSUPA/WCDMA, GSM/GPRS/EDGE
- Worldwide connectivity
- Designed for eX700 and eXware product families.
- Compatible with operation of Corvina Cloud secure service



Highlights

PLCM10 is a compact and robust plug-in module designed to add IoT M2M connectivity to systems based on eX700 Series and eXware.

The device is a 4G wireless modem supporting LTE cat. 4 cellular networks and offers Internet connectivity to systems. The microSIM slot accessible by user and PLCM10 is compatible with operation of EXOR Corvina Cloud secure service.

In combination with Corvina Cloud Remote Monitoring services you can easily implement basic IIoT functions and establish a VPN to protect access to your field devices.

PLCM10 streamlines connection to PaaS cloud services such as Corvina Cloud.

PLCM10 - Technical Data

Cellular Technology	
Frequency Bands	LTE FDD: B1/B2/B3/B4/B5/B7/B8/B12/B13/B18/B19/B20/B26/B28 TDD:B38/B39/B40/B41 WCDMA: B1/B2/B4/B5/B8/B6/B19 GSM: B2/B3/B5/B8
Transmission Data	LTE FDD: Max 150Mbps (DL)/Max 50Mbps (UL) LTE TDD: Max 130Mbps (DL)/Max 35Mbps (UL) UMTS: DC-HSDPA: Max 42Mbps (DL) UMTS: HSUPA: Max 5.76Mbps (UL) UMTS: WCDMA: Max 384Kbps (DL)/Max 384Kbps (UL) GSM: EDGE: Max 296Kbps (DL)/Max 236.8Kbps (UL) GSM: GPRS: Max 107Kbps (DL)/Max 85.6Kbps (UL)
Power output	Class 3 (23dBm±2dB) for LTE FDD Class 3 (23dBm±2dB) for LTE TDD Class 3 (24dBm+1/-3dB) for TD-SCDMA Class 3 (24dBm+1/-3dB) for WCDMA Class E2 (27dBm±3dB) for EDGE 850/900MHz Class E2 (26dBm+3/-4dB) for EDGE 1800/1900MHz Class 4 (33dBm±2dB) for GSM 850/900MHz Class 1 (30dBm±2dB) for GSM 1800/1900MHz
Interface	
Antenna	50Ω, SMA-F Female connector
Digital inputs	2x 24Vdc with optical isolation
Digital outputs	2x SSR with optical isolation
LED indicators	4
SIM slot	microSIM
Plug-in extender	Yes
Wi-Fi	Requires appropriate hardware revision of hosting device. Check Installation Guide for details. IEEE 802.11a/b/g
GNSS	Requires appropriate hardware revision of hosting device. Check Installation Guide for details. GPS, GLONASS, BeiDou/Compass, Galileo, QZSS
Environment Conditions	
Operating Temp	-20°C to +60°C
Storage Temp	-20°C to +70°C
Operating / Storage Humidity	5 - 85% RH, non condensing
Protection Class	IP20
Dimensions and Weights	
WxHxL	41.2x23.8x90.5 mm
Weight	0.2 Kg
Approvals	
CE	Directive 2014/53/EU (RED)
FCC	Part 15, Class A
UL	cULus: UL61010-1 / UL61010-2-201
UL	cULus: Class 1 Div 2
RCM	Currently being defined

- 1 LTE Main Antenna
- 2 GNSS Antenna
- 3 LTE RX Diversity Antenna
- 4 Wi-Fi Antenna
- 5 Plug-in extender
- 6 SIM Slot
- 7 LED Indicators 1-4
- 8 Inputs 1-2 / Outputs 1-2

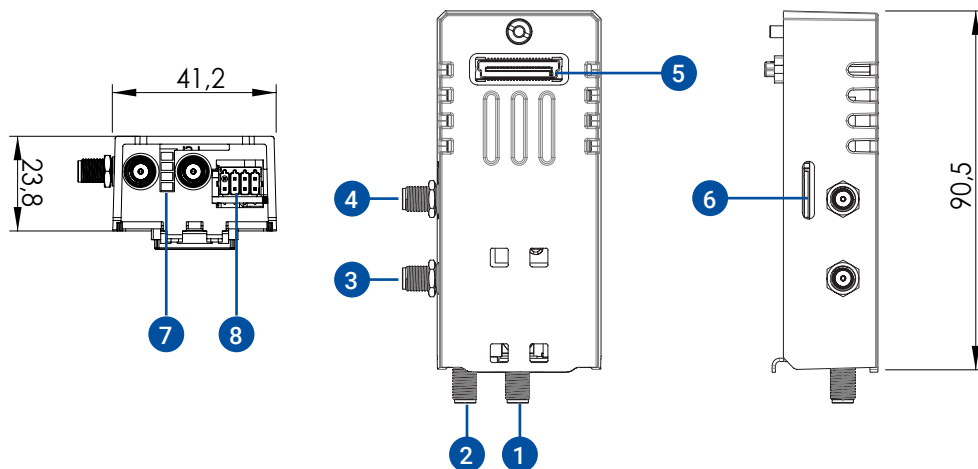

Ordering Information

Model	Part Number	Description
PLCM10	+PLCM10U0P1	LTE Modem Plug-in
ANTENNA001	+R-ANTENNA001	Antenna Wi-Fi 2.4GHz/5.5GHz RP-SMA
ANTENNA002	+R-ANTENNA002	ANTENNA 4G-LTE SMA